

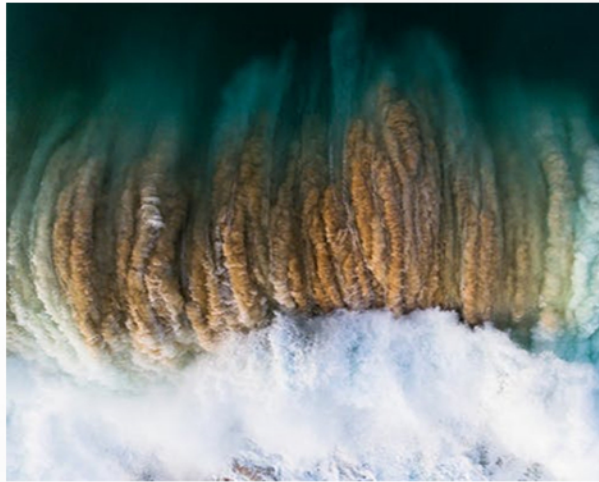

A NEW WAY OF LIVING



The **EVOLUTION** of human adaptation can be traced throughout history during times of climate instability. In present day, we are at the verge of climate instability and once again an apparent evolutionary **change** is needed.

The **cubes** signify the elements currently existing on our planet. They are the resources we've extracted and taken away from earth, gradually adapting the environment to meet our needs. The tables have turned and once again, the earth is fighting back.

The triangle symbolizes a **measurable point** in human history. An evolutionary point in time in which one retraces to our origins and realize our place on this earth. A time we develop ways to eliminate the consumption of resources and establish new methods of using them wisely.

The cubes in which come in contact with the triangle's plane become a two dimensional element that encompasses an **invisible structure**. A structure in which blends with its environment, making it a part of earth.

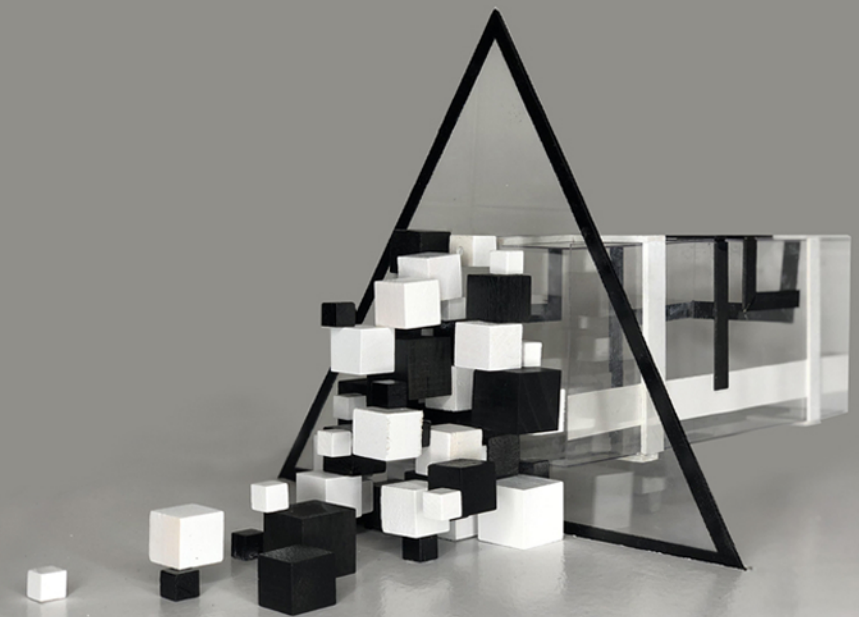
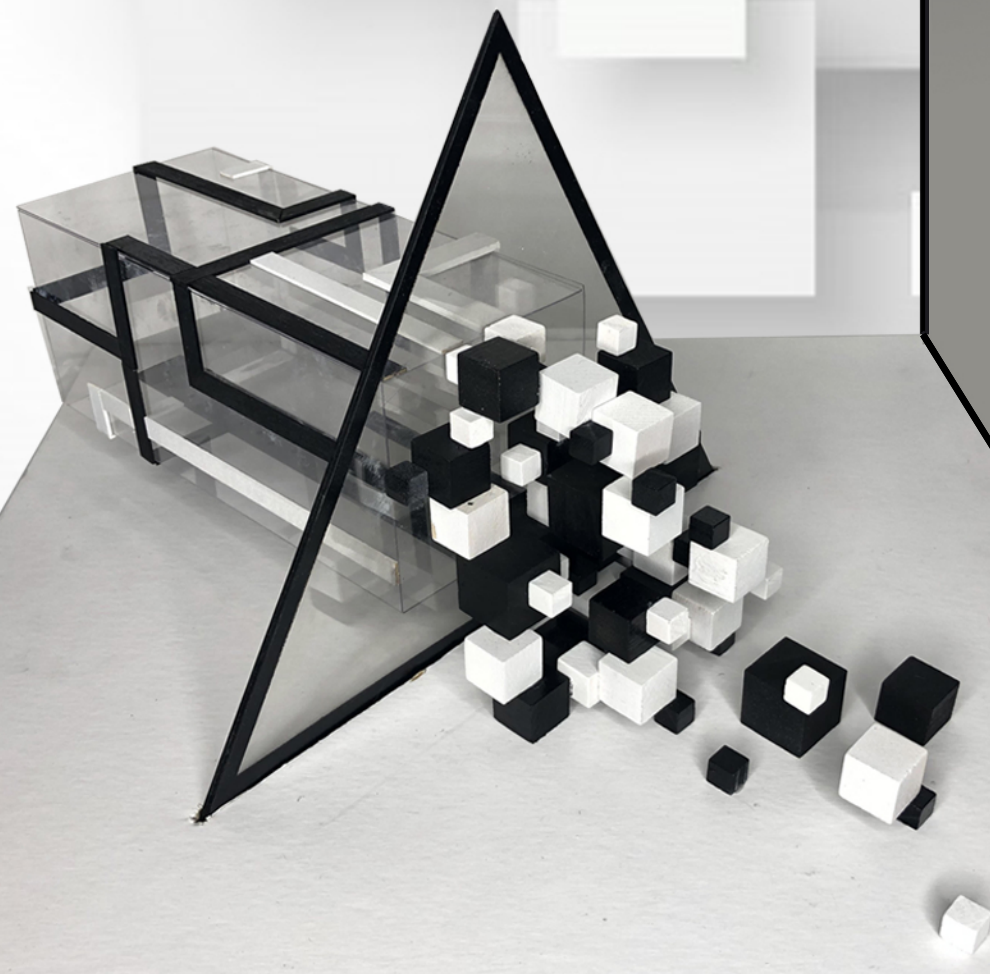

DESIGN DEVELOPMENT

CONTINUOUS PLANES

EXTRUSIONS

TRANSPARENCY

OVERLAPPING

UNIFORM

BALANCED

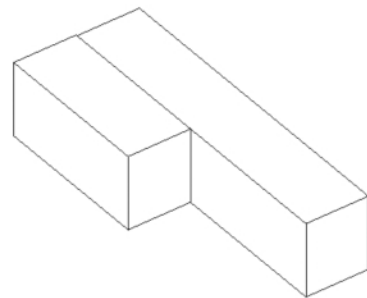
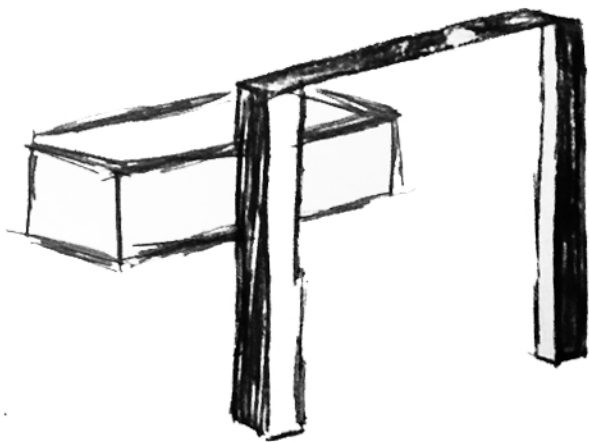
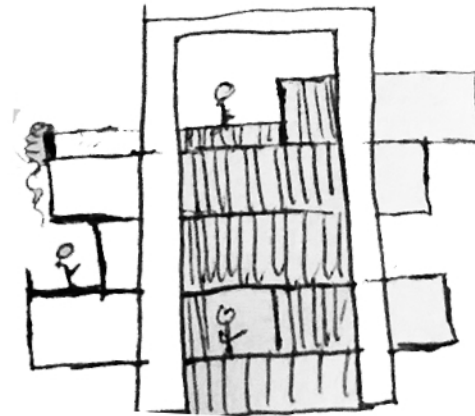
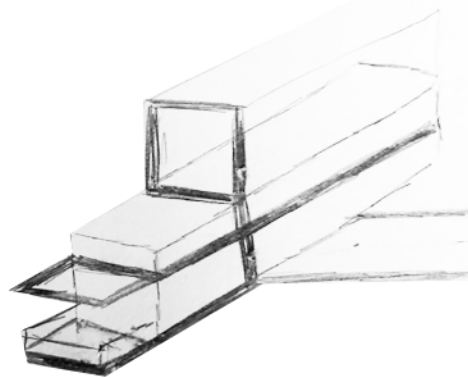
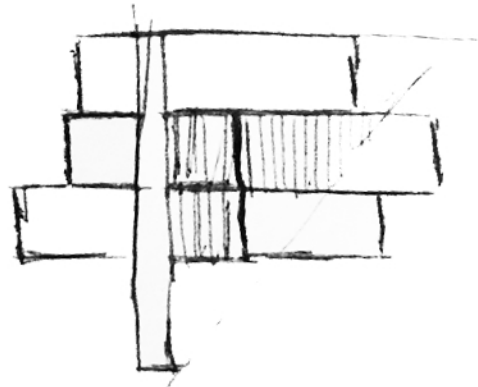

SMALL

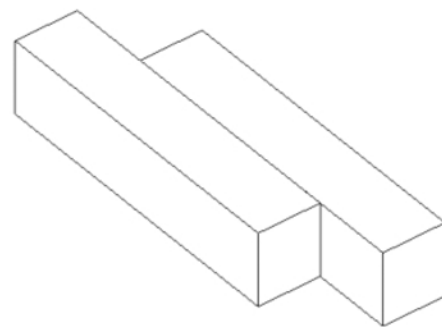

MEDIUM

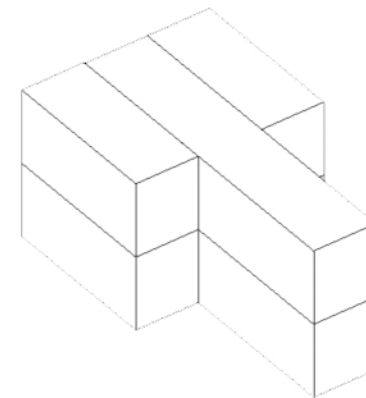

LARGE



**EIGHTY
THREE**
BY EVOLVE



EIGHTY THREE

BY EVOLVE

As a modern approach to adaptive re-use, Eighty Three is the number of containers it took to create our community.

While offering waterfront views and resort amenities, short and long term leases allow for adaptability. Community is encouraged through weekly events and memberships to the on site wellness and community center.

Offering luxury living in smaller spaces and keeping sustainability as a priority, Eighty Three gives back to the community.

EVOLVE

verb. [e ·volve]

to develop gradually, especially from a simple to a more complex form.

Evolve is a new development which paves the way to a sustainableutopian community. The historical site of Miami's Womens Club in Edgewater, Florida allowed the opportunity for an extensive adaptive reuse development.

The waterfront property allowed for develomental strategies to combat sea level rise and the vacant land called for its return to native mangroves.

92 % of milenials believe in **climate change**

88% believe rainwater collection for irrigation helps minimize consumption of natural resources

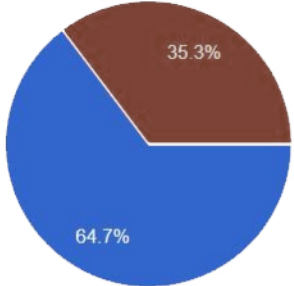

64% found **corrugated metal** to be more aesthetically pleasing than a brick wall

72% were willing to sacrifice space for lower rent costs

86% agreed bike storage was a necessity

94% agreed access to sunlight is imporant for well-being

72% of individuals favored personal gardens for food supply

76% of individuals were willing to ride a stationary bike for exercise in return of lower energy costs.

90% of individuals believed water efficient fixtures and energy star rated appliances help contribute to climate change

97% agreed acoustical privacy was essential in living quarters

E B D



Evidence based design

As many millenials share a common interest in balance within their lives, they hold a high regard towards personal pursuits such as happiness. They hold ambitious personalities, want flexibility within workplace, and expect to be rewarded for hard work.

Unfortunately milenials also hold cons to their parental nutured personalities. Some which may include not attending college or financial instability.

However, their personal views about how previous generations attributed to climate change hold a solid ground. Most millenials are generally concerned about our planet. This influenced our demographic choice in the development of our research and future project.

The most useful information used for design development was taken from a survey conducted

EIGHTY THREE - SITE PLAN

1ST LEVEL - FLOOR PLAN

SCALE: 1/8" = 1'

